

PLAN SHOWING THE REGULARISATION OF SIT OUT & OPEN STAIR CASE. AND PROPOSED ADDITIONAL CONSTN. OF COMPOUND WALL AT PLOT No.-66, BLOCK No.-1 - T. S. No. 305 Pt., MOGAPPAIR VILLAGE. - MOGAPPAIR EAST S & S. SCHEME, TNHB, MADRAS.

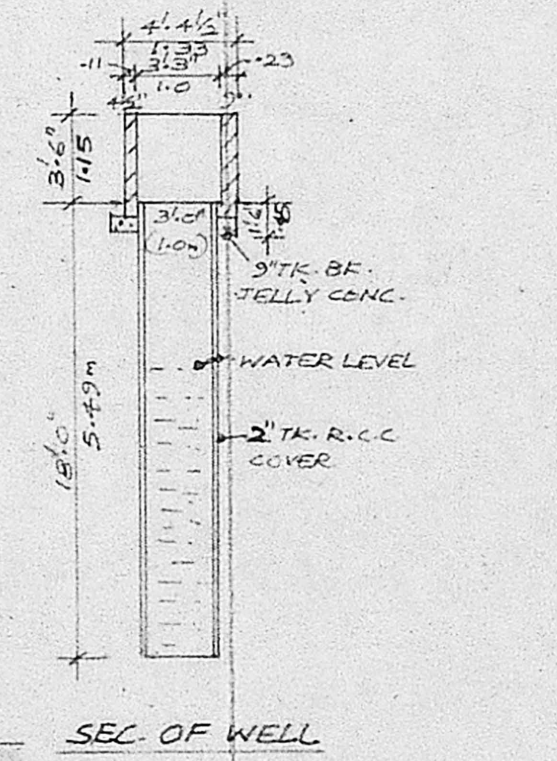
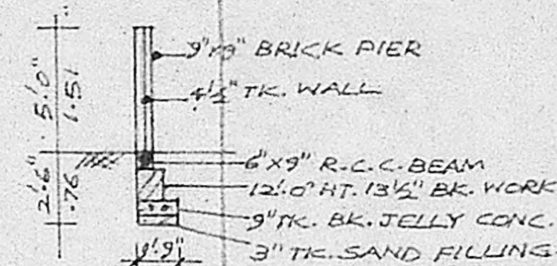
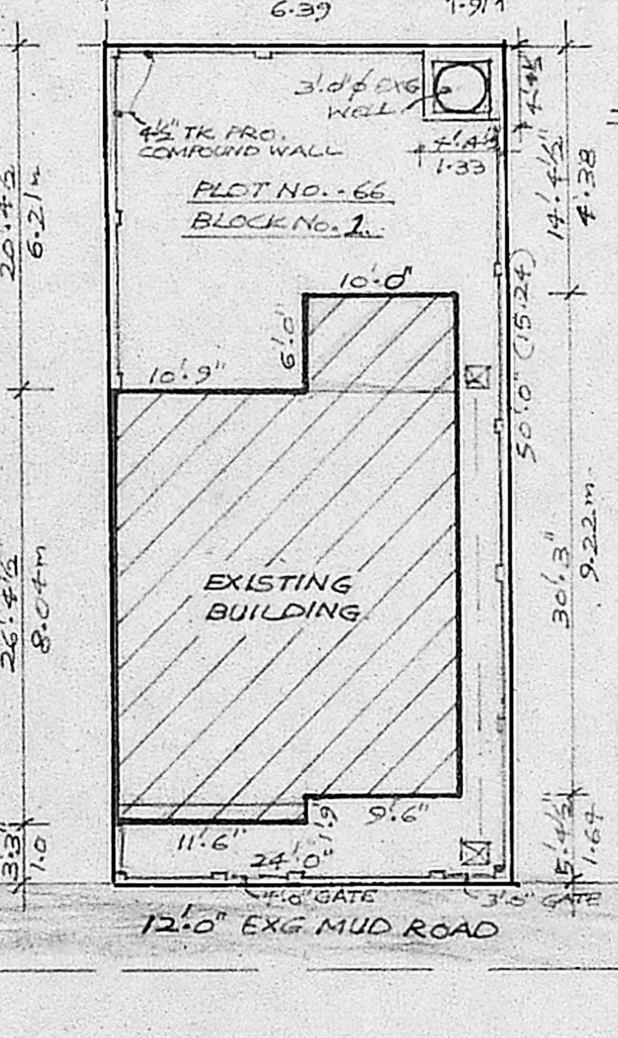
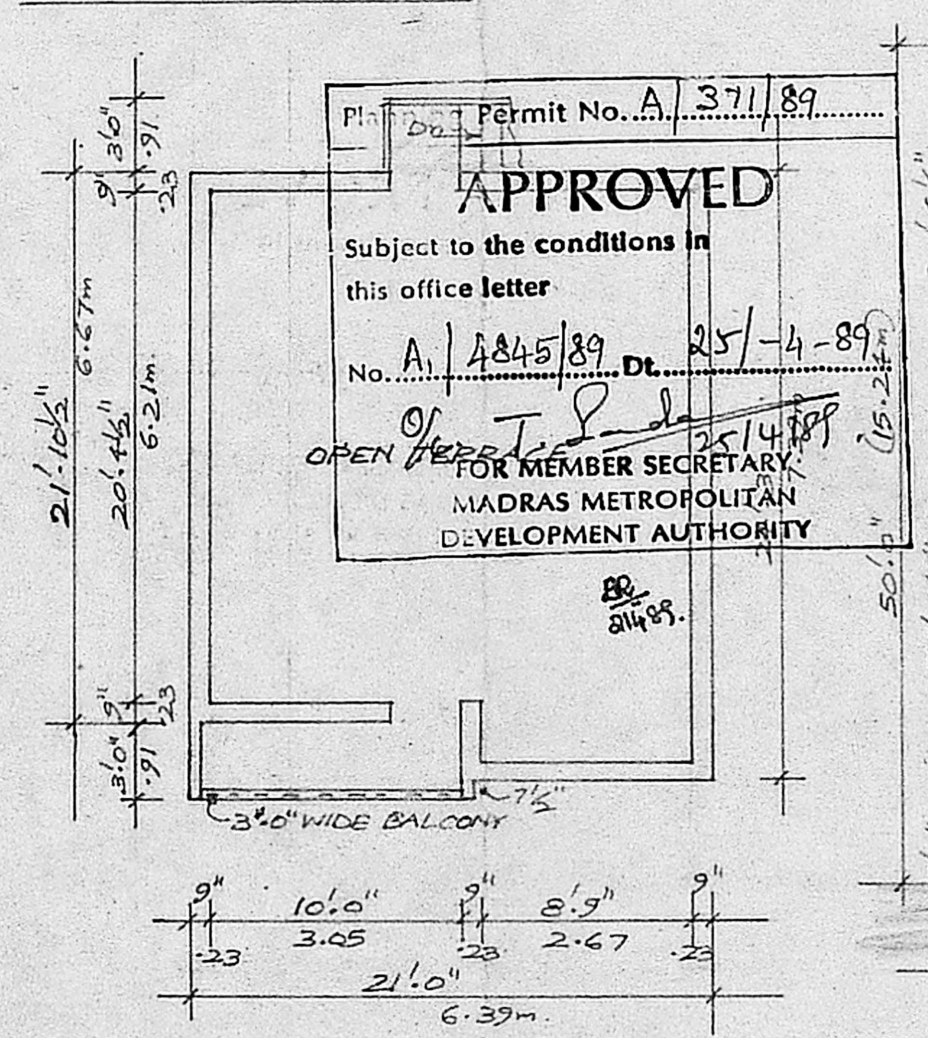
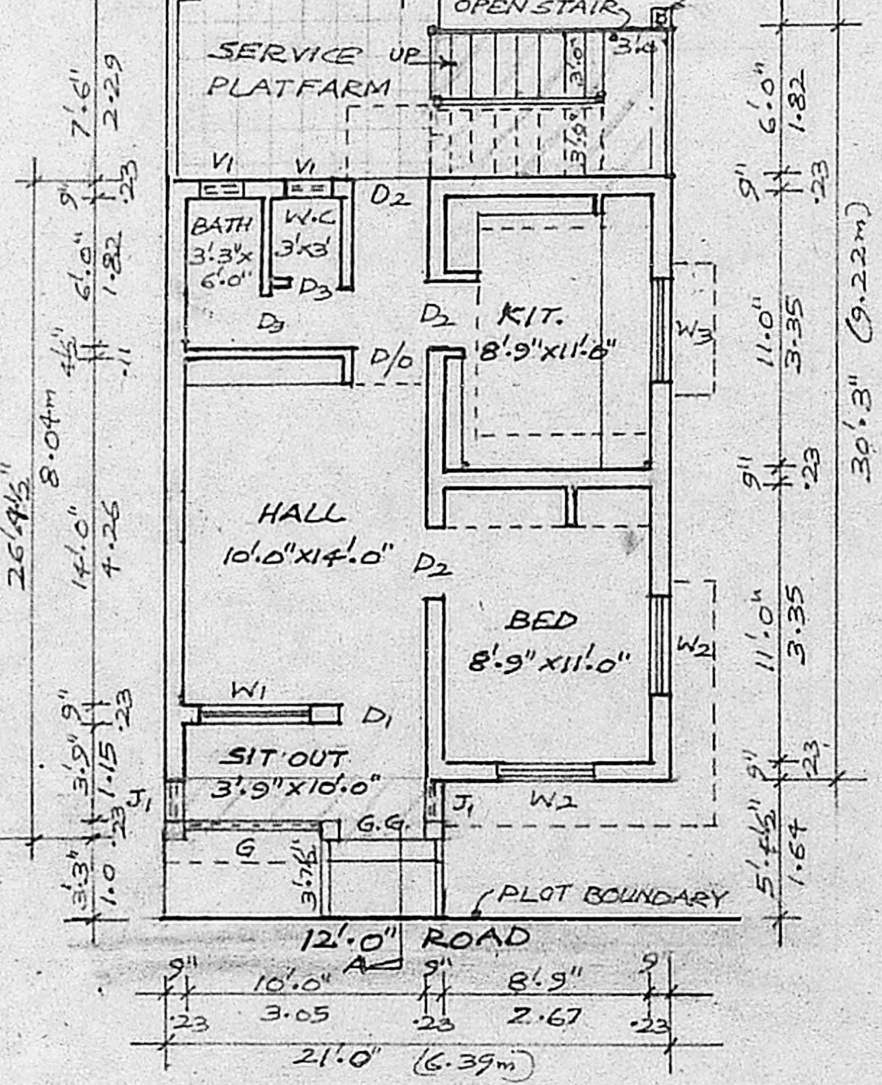
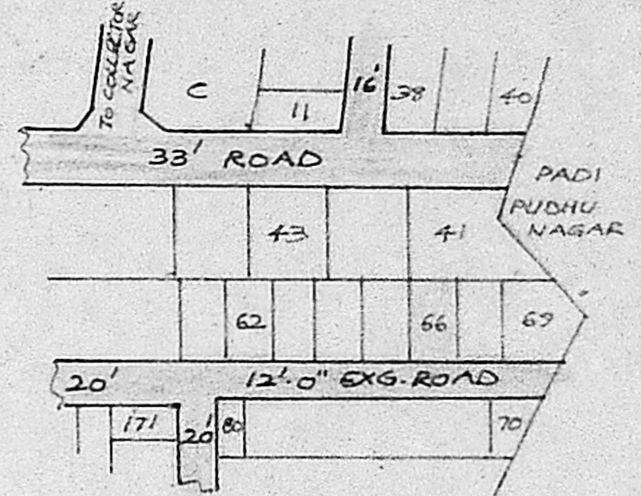
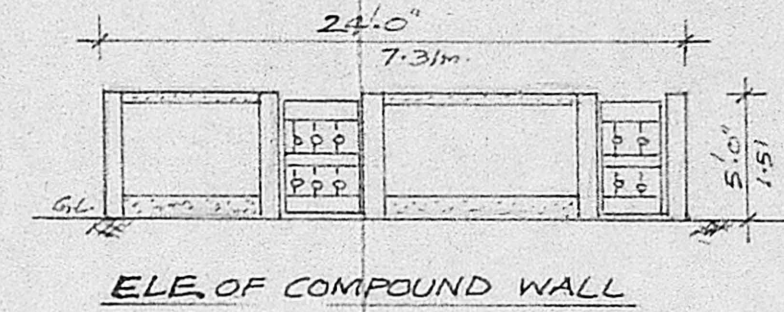
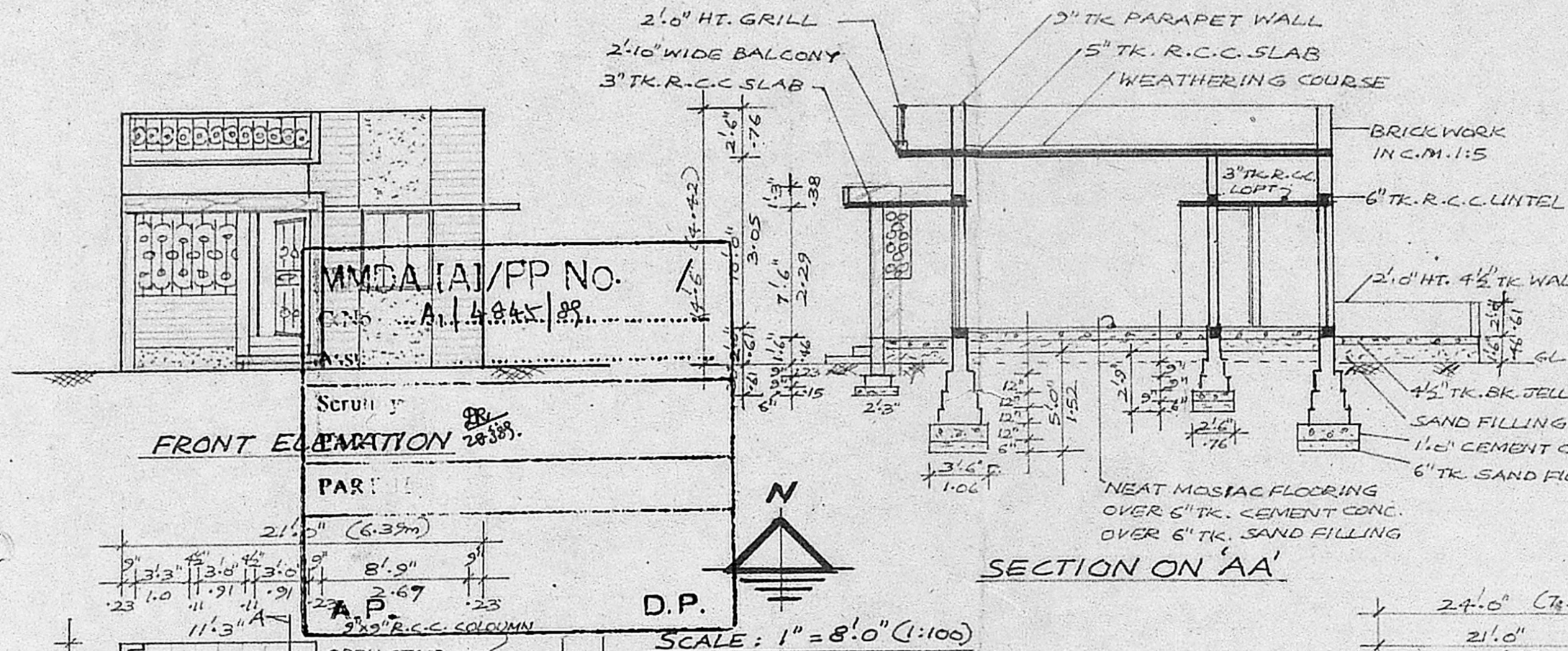

Permit No. A/371/89
APPROVED
 Subject to the conditions in this office letter
 No. A/4845/89 Dt. 25/4-89
 FOR MEMBER SECRETARY,
 MADRAS METROPOLITAN DEVELOPMENT AUTHORITY

REFERENCE

D/O	3'-0" x 7'-0"	DOOR OPENED
D1	3'-6" x 7'-0"	PANELLED DOOR
D2	2'-9" x 7'-0"	PANELLED DOOR
D3	2'-3" x 7'-0"	PANELLED DOOR
W1	4'-6" x 4'-6"	PANELLED WINDOW
W2	4'-0" x 4'-6"	PANELLED WINDOW
W3	4'-0" x 3'-6"	PANELLED WINDOW
V1	2'-8" x 1'-6"	GLAZED VENTILATOR
J1	1'-6" x 4'-6"	R.C.C. JOLLY
G	5'-9" x 5'-0"	GRILL
GG	3'-6" x 7'-3"	GRILL GATE

BUILT UP AREA	585	Sq. m	54.40 (49%)
PLOT AREA	1200	Sq. m	111.60

- EXISTING WORK
- TO BE REGULARISED
- PROPOSED WORK
- ROADS
- PLOT BOUNDARY

V Venkatesan
V. VENKATESAN, B.E., M. Sc., M. L. S.
 CIVIL ENGINEER
 LICENSED SURVEYOR,
 AMBATTUR TOWNSHIP,
 B, Sower St., Romakrishnapuram
 AMBATTUR, MADRAS-600053

Ge. Pranjay
 SIGNATURE OF OWNER

GROUND FLOOR PLAN

OPEN TERRACE PLAN

SITE PLAN
 SCALE: 1"=12'-0"